

Clamping unit		VM 40/... R752							
Clamping force	kN	400							
Rotary table diameter	mm	752							
Working height	mm	995							
Mold height (min.)	mm	250							
Opening stroke/opening force	mm/kN	250/77							
Max. daylight	mm	500							
Ejector stroke/ejector force	mm/kN	150/27,5							
Cooling circuits/temperature/nominal size/connecting thread	n/°C/mm	2/120/9 - G3/8"							
Angle of rotation/time of rotation	°/s	180/1,9							
Dry cycle time ¹⁾	s-mm	2,8 - 150							
Injection unit		60 H V			130 H V				
Screw diameter	mm	14	18	22	18	22	25	30	
Screw stroke	mm	90			110		125		
Screw L/D ratio		20			20		22		
Theoretical shot volume	cm ³	13,9	22,9	34,2	28	41,8	61,4	88,4	
Specific injection pressure	bar	3000	2593	1736	3000	2864	2218	1540	
Screw speed	min ⁻¹	623			398				
Max. plasticizing rate (PS) ²⁾	g/s	1,9	6,2	9	4	5,8	10,5	15,4	
Max. screw torque	Nm	90	231		238		357		
Nozzle stroke/contact force	mm/kN	350/47			350/47				
Injection rate into air ³⁾	cm ³ /s	40,9	67,6	101	40,9	61,1	78,9	114	
Injection rate into air with double pump	cm ³ /s	65	108	161	65,5	97,8	126	182	
Drive									
Drive power	kW	11				11			
Oil tank volume	l	180				180			
Electrical power supply without options	kVA	20				24			
Weight, dimensions									
Netweight (exclusive oil)	kg	4300				4400			
H - Length x width x height ³⁾	m	3,2 x 1,5 x 2				3,2 x 1,5 x 2			
V - Length x width x height ³⁾	m	3,2 x 1,5 x 3,2				3,2 x 1,5 x 3,5			
Max. mold weight ⁴⁾	kg	400				400			
Min. mold diameter	mm	200				200			

¹⁾ according to EUROMAP 6

²⁾ according to Wittmann Battenfeld Norm

³⁾ max. length with middle screw diameter in back position

⁴⁾ on rotary table

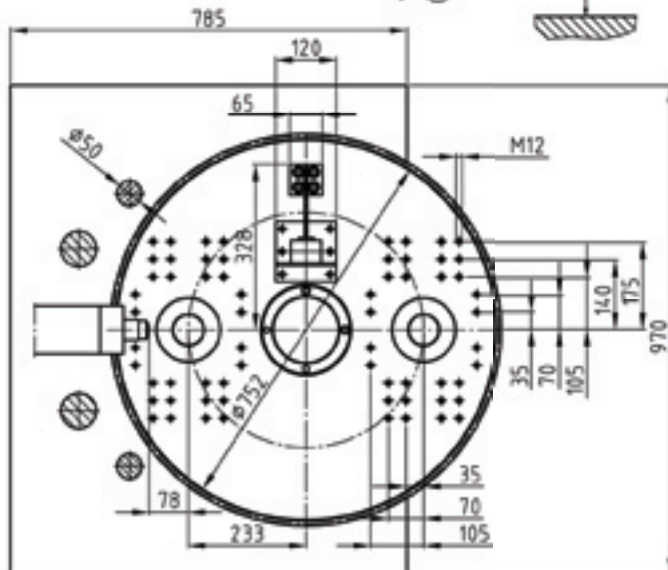
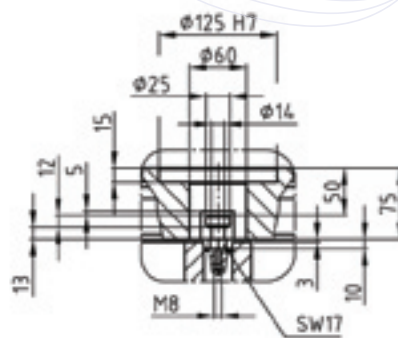
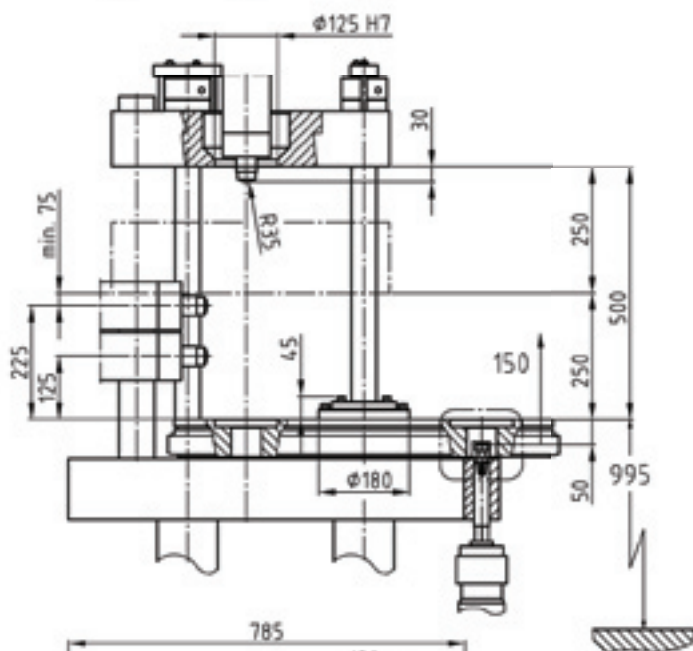
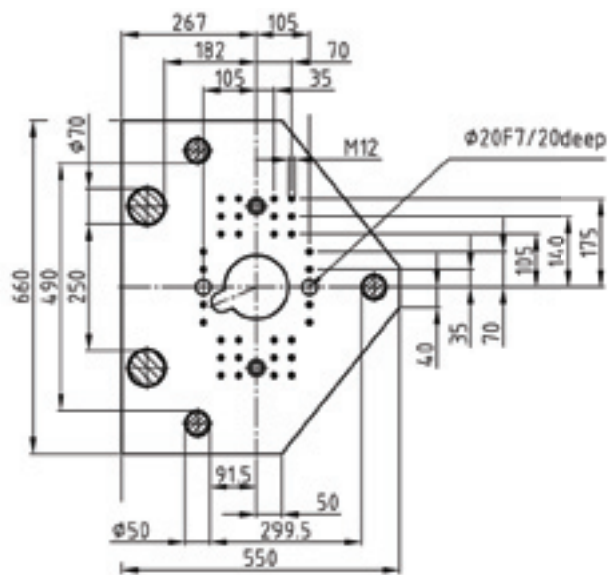

752 mm